



Veter Models®

Speed Fighter

Assembly instruction
Инструкция по сборке



ENG

Assembly manual

This model is assembled without glue. Please remove carefully selected details following the sequence according to the a numeration color. Try not to break them. For comfortable taking out of the parts use **TOOL**. If a part does not remove easily, carefully cut it out with a knife. It is necessary to grease parts in places that are shown in the manual. If lubrication is not shown, but it is assembled with difficulties, grease the parts.

TOOL



2

RUS

Инструкция по сборке

Данная модель собирается без клея. Осторожно вынимайте выделенные детали соблюдая последовательность согласно цвету нумерации. Старайтесь не поломать. Для удобного извлечения деталей используйте **TOOL**. Если деталь не извлекается, надрежьте перемычки ножом. Обязательно смазывайте детали в местах, которые показаны на инструкции. Если смазка не показана, но собирается туго - смажьте детали.

POL

Instrukcja montażu

Model ten jest montowany bez użycia kleju. Ostrożnie usuń zaznaczone części, przestrzegając kolejności zgodnie z kolorem numeracji. Staraj się nie złamać. Dla łatwego wyciągnięcia detali wykorzystuj **TOOL**. Jeśli detal nie poddaje się, podetnij wążadła nożem. Obowiązkowo smaruj detale w miejscach, które są pokazane w instrukcji. Jeśli smarowanie nie jest wskazane, lecz trudno montuje się - naoliw detale.

UKR

Інструкція по збірці

Дана модель збирається без клею. Обережно виймайте виділені деталі дотримуючись послідовність згідно кольором нумерації. Намагайтесь не зламати. Для зручного витягнення деталей використовуйте **TOOL**. Якщо деталь не виймається, надіріть перемички ножом. Обов'язково змазуйте деталі в місцях, які позначені на інструкції, для того, щоб вони краще збирались і для забезпечення меншого тертя під час роботи. Якщо змащення не зображене, але збирається туго - змастіть деталі.

SPA

Instrucciones de montaje

Este modelo se ensambla sin pegamento. Retire con cuidado las piezas resaltadas, observando la secuencia según el color de la numeración. Trate de no romper. Para una fácil separación de las partes utilice **TOOL**. Si una pieza no se saca, haga una incisión. Asegúrese de lubricar las piezas en los lugares que se muestran en las instrucciones. Si no se muestra la grasa, pero se ensambla con dificultad - lubrique las partes.

DEU

Bauanleitung

Dieses Modell wird ohne Verklebung gebaut. Entfernen Sie vorsichtig markierte Teile nach der Reihenfolge entsprechend der Nummerierungsfarbe. Vermeiden Sie das Beschädigen der Teile. Zum bequemerem Herausziehen der Teile verwenden Sie das **TOOL**. Wenn sich ein Teil nicht herausnehmen lässt, schneiden Sie die Stege mit dem Messer leicht an. Schmieren Sie unbedingt die Teile an den in der Anleitung gezeigten Stellen. Wenn die Schmierung nicht angezeigt ist und der Zusammenbau der Teile kraftaufwendig ist - schmieren Sie die Teile.

ITA

Guida dell'assemblaggio

Questo modello viene assemblato senza colla. Rimuovete con attenzione le parti selezionate, rispettando la sequenza, in base al colore della numerazione. Cercate di non romperli. Per rimuovere facilmente i dettagli usate **TOOL**. Se un particolare non si stacca, tagliare delicatamente gli elementi di collegamento con un coltello. Lubrificare senz'altro le parti in luoghi indicati nella guida per il loro assemblaggio. Se il lubrificante non è indicato, ma viene assemblato a stretto - allora lubrificate anche queste parti.

FRA

Notice de montage

Ce modèle se construit sans colle. Retirez doucement les détails sélectionnés en suivant la séquence selon la couleur de numérotation. Essayez de ne les pas casser. Pour faciliter l'arrachage des pièces utilisez **TOOL**. Si la pièce ne sort pas, incisez les collages/fixations avec un couteau. Assurez-vous de lubrifier les pièces dans les endroits qui sont indiqués à l'instruction. Si la graisse n'est pas nécessaire, mais on construit mal, lubrifiez les pièces.

TUR

Kurulum talimatı

Bu model yapıştırıcı kullanmadan yapılmaktadır. İşaretlenmiş parçaları, numaralannın renklerindeki sıraya uyarak dikkatle çıkarın. Kırılmamasına dikkat ediniz. Parçaların rahatlıkla çıkarılması için **TOOL**. Parça çıkarılmıyorsa bağlantı yerleri bıçakla kesiniz. Klavuzda gösterilen yerlerde, daha iyi bir şekilde monte edilmesi ve çalışırkenki sürtünmeyi azaltmak için yağlanmasını gerektir. Yağlama yeterli olmaz ise, parçaları bir araya getirildiğinde tekrar gresleyiniz.

JAP

組立のために指導
このモデルは組合列なしで組立て
られます。慎重に、番号付けの図によ
って順番に選ばれたパーツを取り換
えてください。何も壊さないよう
にしてください。便利な部品の出庫に
は、TOOLを使用して下さい。部品
を取出すことができない場合は、
ナイフでジャンパーを切断します。
必ず指導に示されている場所での部
品を交換してください。場所がマ
ークされていない場合に、それにし
ても、組立する際は注意してください。



KOR

조립 설명서
이 모형은 합착재질이 포함됩니
다. 번호 매겨서의 색상에 따라
순서를 준수하면서 강조 표시된
부품을 조심스럽게 교체하십시오. 깨지
거나 부러지지 않도록 주의하
십시오. TOOL을 사용하여 부품을
정리하게 떼어냅니다. 어떤 경우
도 부품들 떼어낼 수 없으면 칼
로 절리를 자릅니다. 설명서에 표
시된 곳에서 부품에 절단유를 바
르십시오. 절단유가 필요하지 않
지만 수월하기가 간단한 경우 부
품에 절단유를 바르십시오.



CHI

組立説明書
此模型不需要使用拆水器具。
根據編與顏色小心地取出組裝的配件。
學要不要弄壞零件。
為了方便零件取出，請使用專用工
具。如果零件無法取出，請使用專
用拆線剪剪。一定要在說明書所示
的位置上進行剪線。如果說明書
中沒有顯示需要施加潤滑油，但顯
明時感覺零件安裝的很緊，請在此
零件上施加潤滑油。



ENG Grease the part with a paraffin candle.
RUS Смажьте детали парафином.
UKR Змастіть деталі парафіном.
DEU Schmierens Sie den Teil mit Paraffinwax.
FRA Lubrifiez du détail par la bougie de paraffine.
POL Naolej detal parafinową.
SPA Engrase una pieza con una vela de parafina.
ITA Grassare un pezzo con una candela di paraffina.
TUR Parafin parafin mumsu kullanın.
JAP パラフィン・ロウソクで部品を潤滑します。
KOR 부품의 윤활유 부분을 윤활하십시오.
CHI 潤滑配件的潤滑部分。

ENG Pay attention to the positioning (be careful).
RUS Обратить внимание на установку (быть осторожным).
UKR Звернути увагу на встановлення (бути уважливим).
DEU Beachten Sie die Position (passen Sie auf).
FRA Faites attention à la position (soyez attentif).
POL Zwróć uwagę na położenie (bądź ostrożny).
SPA Presta atención a la posición (sé algo cuidadoso).
ITA Prestare attenzione alla posizione (stare attenti).
TUR Dikkat Parçaları konumlandırma kısmını kontrol etmeye çalışın.
JAP 位置には注意する必要があります。
KOR 위치에 주의하십시오.
CHI 請注意零件的位置。

ENG The parts have to move freely.
RUS Детали должны свободно двигаться.
UKR Деталі повинні вільно рухатися.
DEU Die Teile sollen frei drehbar sein.
FRA Les détails doivent tourner librement.
POL Detale muszą swobodnie przemieszczać się.
SPA Las piezas deben ser libres de moverse.
ITA Le parti devono essere libere di muoversi.
TUR Parçalar birbirine nispeten özgürce hareket etmeye çalışın.
JAP 部品は自由に移動する必要があります。
KOR 부품이 자유롭게 움직여야 합니다.
CHI 零件是彼此能活動。

ENG The parts have to be rotated freely.
RUS Детали должны свободно вращаться.
UKR Деталі повинні вільно обертатися.
DEU Die Teile sollen frei drehbar sein.
FRA Les détails doivent tourner librement.
POL Detale muszą swobodnie obracać się.
SPA Las piezas se deben girar libremente.
ITA I dettagli devono ruotare liberamente.
TUR Parçaların serbestçe dönmeye gerekir.
JAP 部品は自由に回転する必要があります。
KOR 부품은 자유롭게 회전해야 합니다.
CHI 零件是彼此能活動。

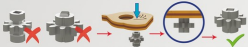

ENG Grease all the inserting areas of the parts.
RUS Смажьте все вставляемые части детали.
UKR Змастіть всі вставляючі частини деталі.
DEU Schmierens Sie alle hineinzufügenden Teile.
FRA Lubrifiez toutes les parties entrantes de détails.
POL Naolej wszystkie części wstawianej detali.
SPA Engrase todas las partes de entrada de las piezas.
ITA Grassate tutte le parti entranti dei dettagli.
TUR Parafin ile her girin birleştirme yaptığınız.
JAP すべての穴の挿入部分を潤滑してください。
KOR 부품의 모든 삽입 영역에 그리스를 바르십시오.
CHI 潤滑配件的插入部分。

ENG Grease all the details surface.
RUS Смажьте всю поверхность детали.
UKR Змастіть всю поверхню деталі.
DEU Schmierens Sie die gesamte Oberfläche des Teiles.
FRA Lubrifiez toute la surface du détail.
POL Naolej całą powierzchnię części.
SPA Engrase toda la superficie de las piezas.
ITA Grassi tutta la superficie della parte.
TUR Parçanın bütün yüzünü yağlayın.
JAP パーツのすべての表面をグリスしてください。
KOR 부품의 전체 표면에 그리스를 바르십시오.
CHI 潤滑配件的整個表面。

ENG The parts have to be inserted tightly to the end.
RUS Детали должны быть вставлены плотно до конца.
UKR Деталі повинні бути вставлені щільно до кінця.
DEU Die Teile sollen bis zum Anschlag fest aufgesetzt werden.
FRA Les détails doivent être mis serré à la fin.
POL Detale powinny być wcześniejsze wcałowane do końca.
SPA Las piezas deben estar bien colocadas hasta el fin.
ITA I dettagli devono essere strettamente inseriti fino alla fine.
TUR Parçalar sonuna kadar ve sıkı bir şekilde içine girmelidir.
JAP パーツは、きつめに挿入する必要があります。
KOR 부품은 끝까지 단단히 삽입되어야 합니다.
CHI 配件必須要緊地插到末端。

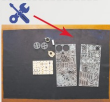

ENG Spare parts. RUS Запасные детали.
UKR Запасні деталі. DEU Ersatzteile.
FRA Pièces de rechange. POL Części zamienné.
SPA Piezas de repuesto. ITA Parti di ricambio.
TUR yedek parçalar. JAP スペアパーツ
KOR 예비 부품 CHI 备用零件



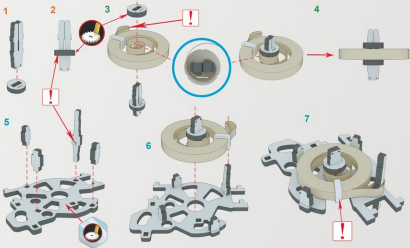

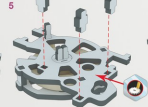
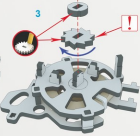
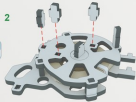
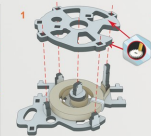
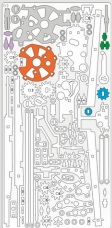

1



2



3



4



5



7

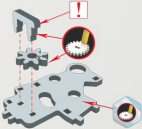

8



6

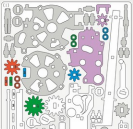

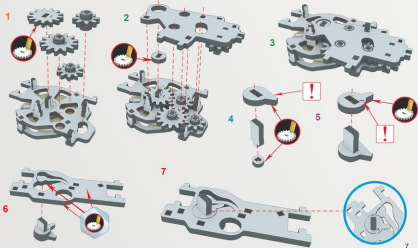

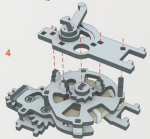
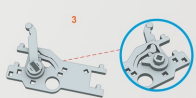
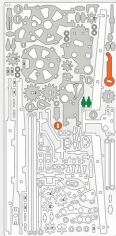

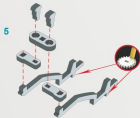
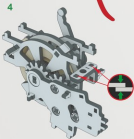
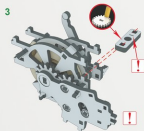
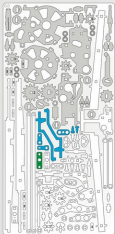

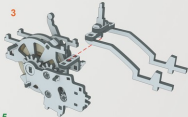
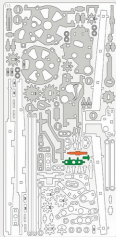

5

4



6



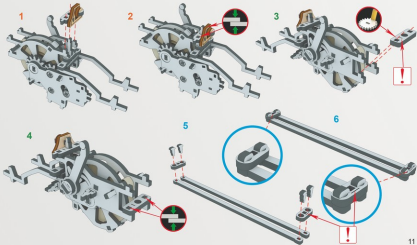
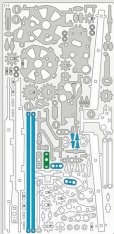

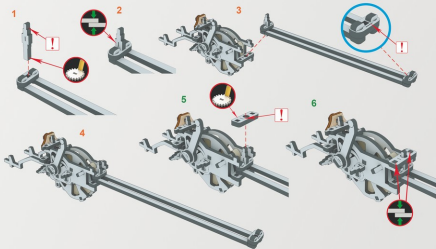
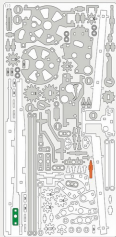

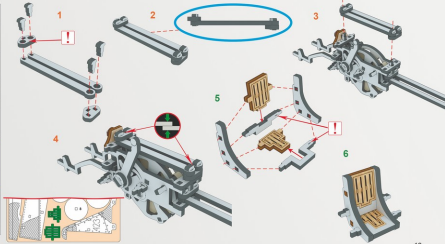

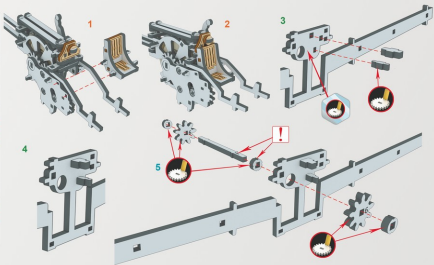
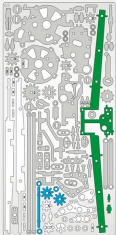

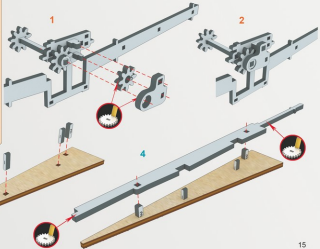
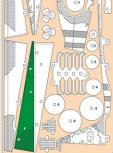
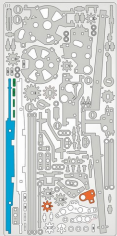

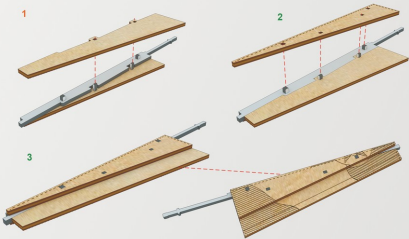
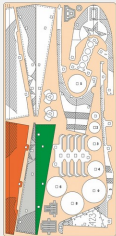

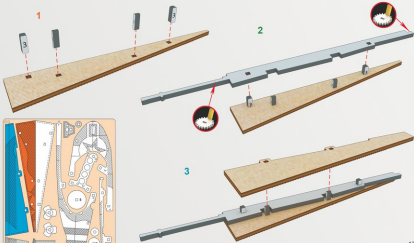
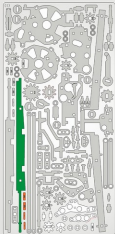

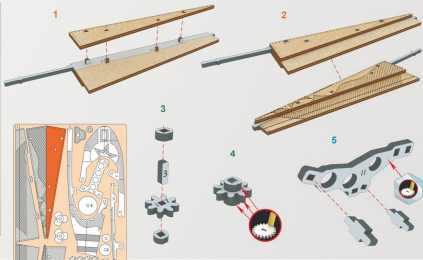

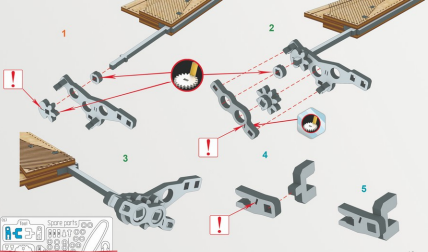

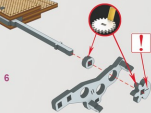
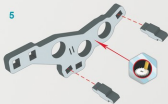
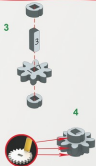

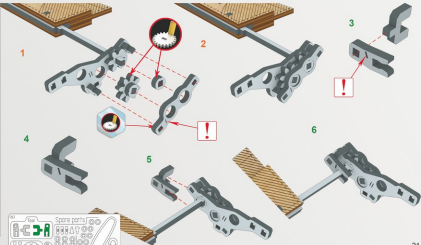
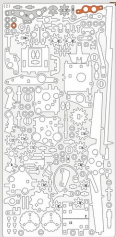



1



2



3

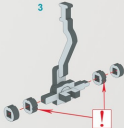

4



5



6

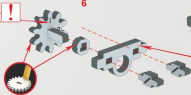

7

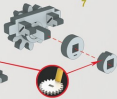

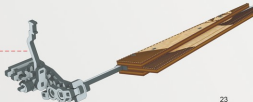
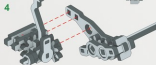
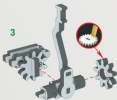
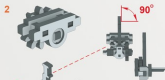
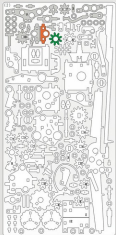

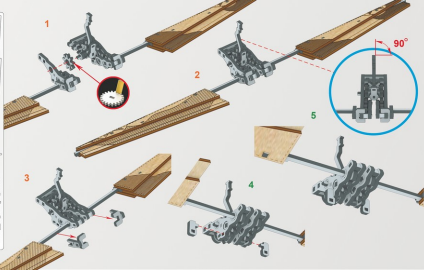

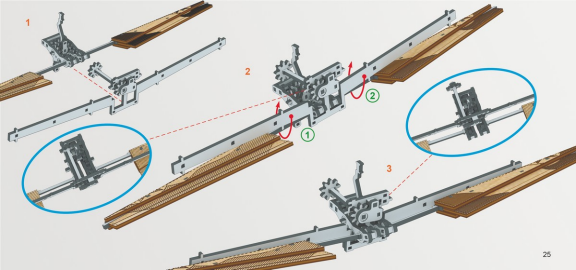

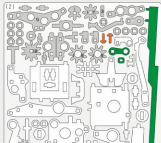
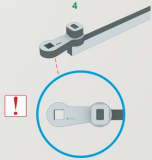
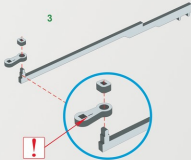
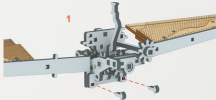

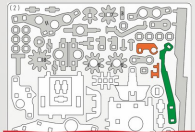

3



1



2



4



5

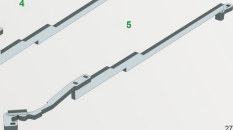

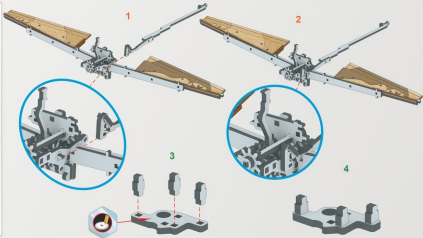
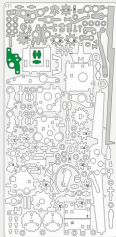

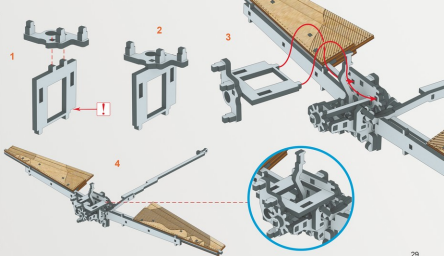
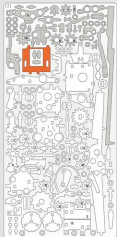

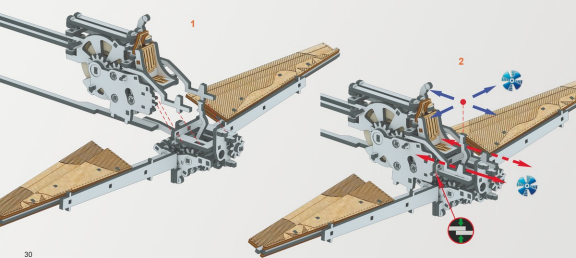

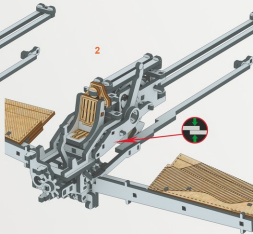
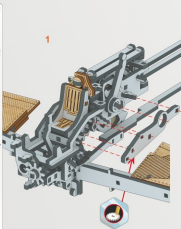
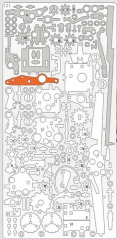

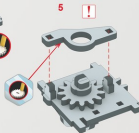
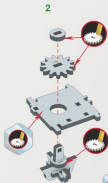
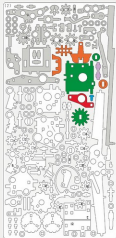

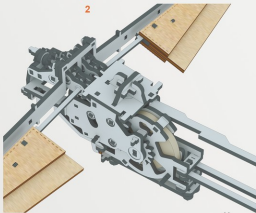
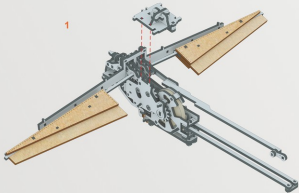

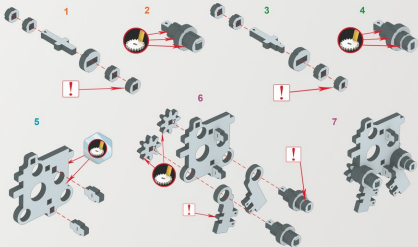

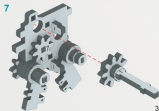
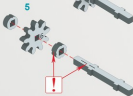
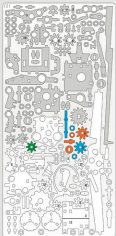

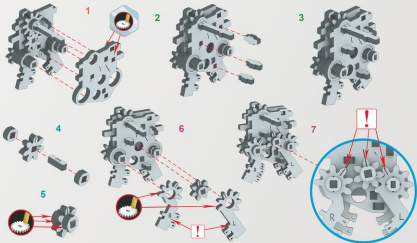

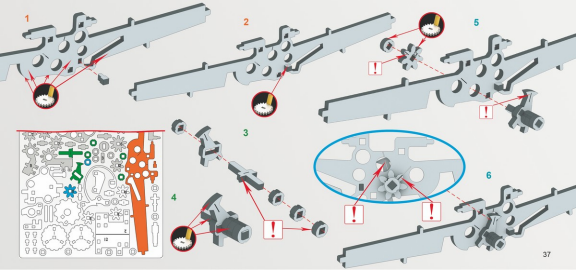

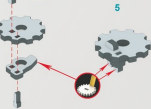
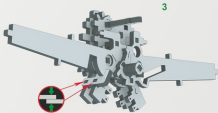
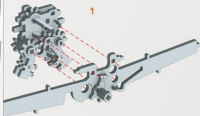

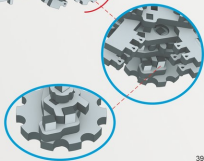
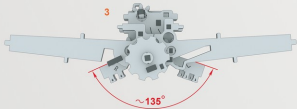
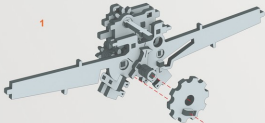

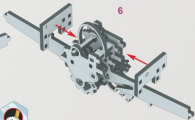
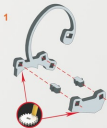
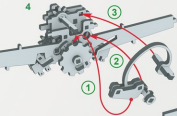

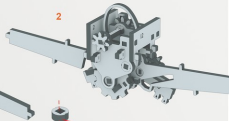
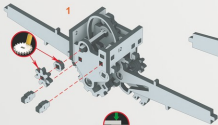
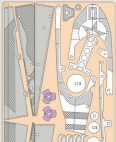

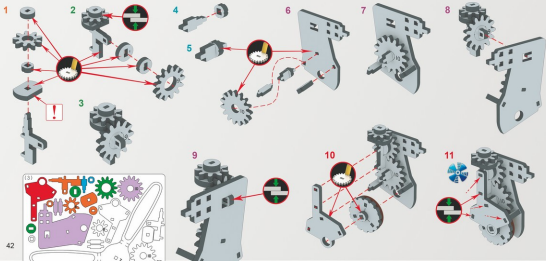

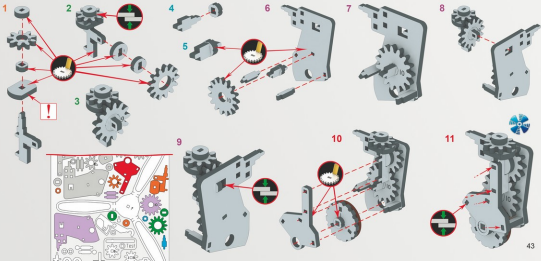

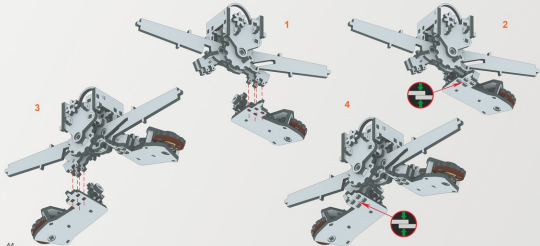

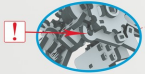
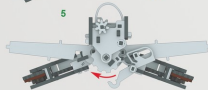
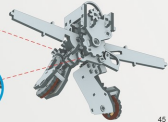
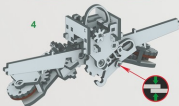
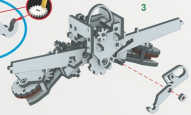

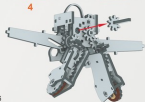
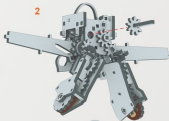

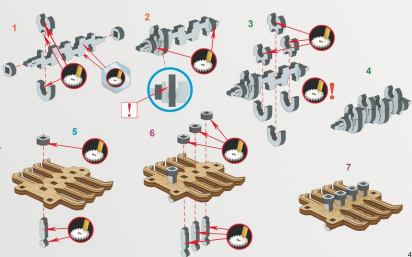
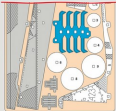
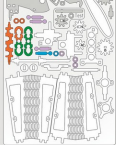

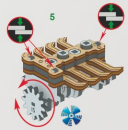
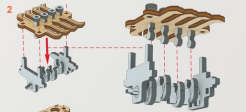
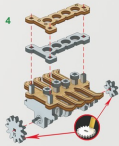
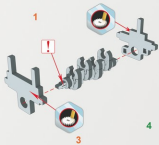
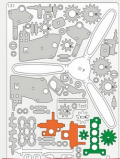

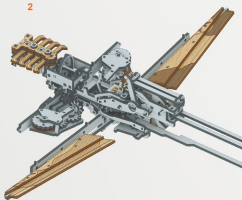
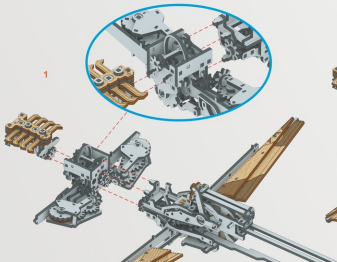

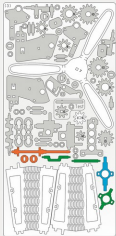

50

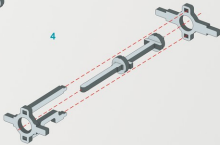
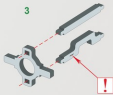
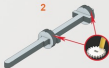

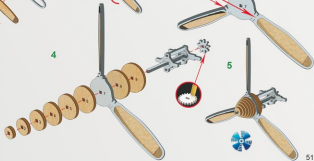

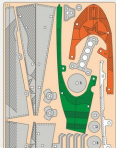
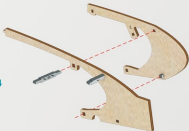

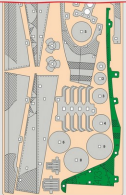



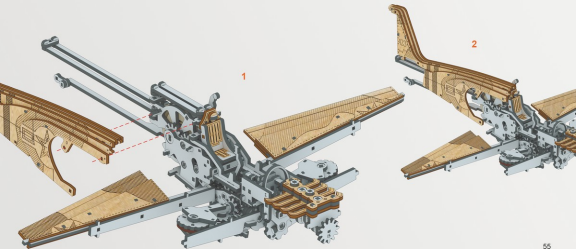

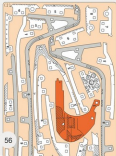

3

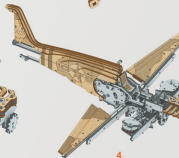

4



1



2



3

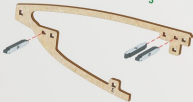

4





58

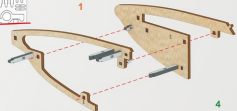

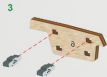
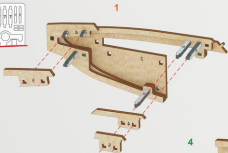

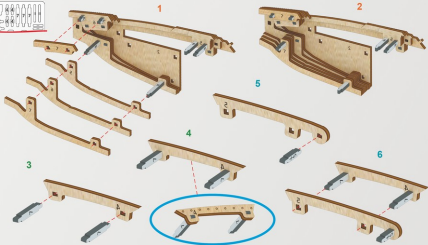

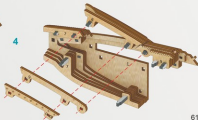
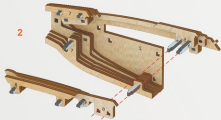
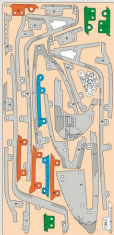

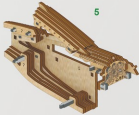
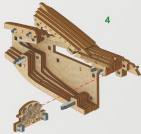
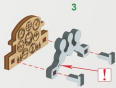
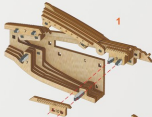
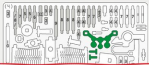

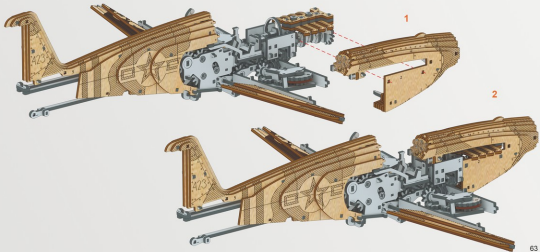

1

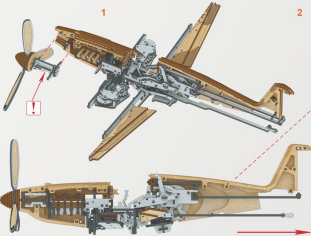

2

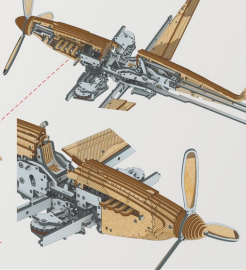

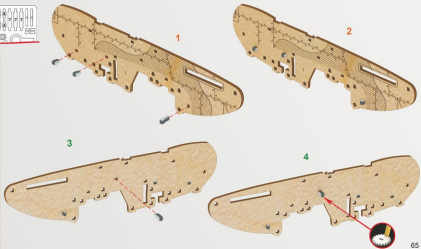

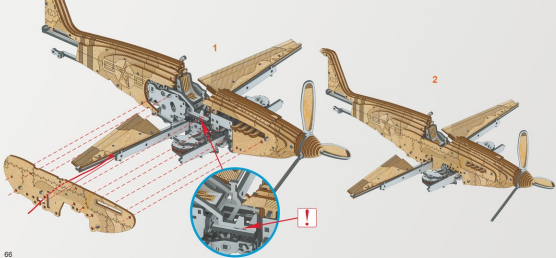

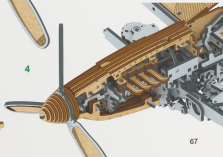
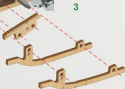
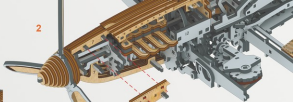
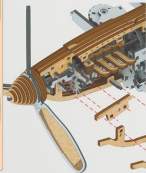
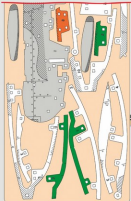

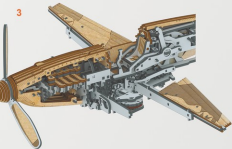
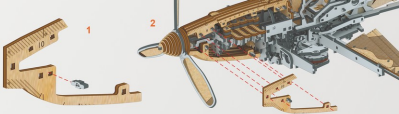

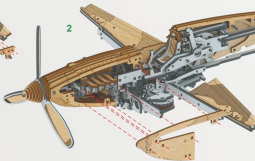
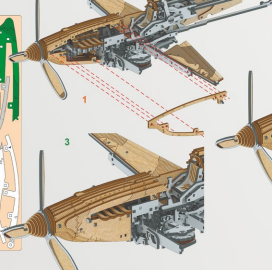
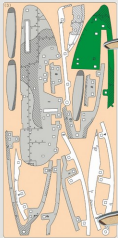

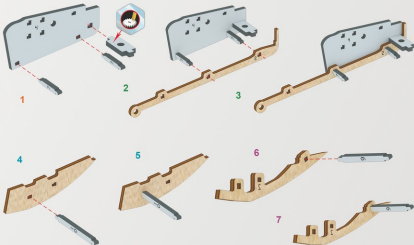

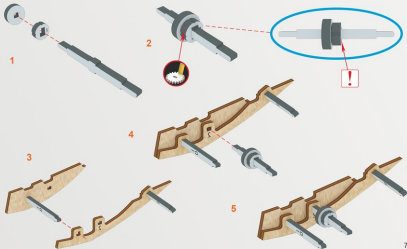
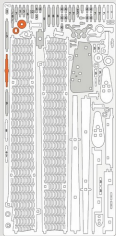

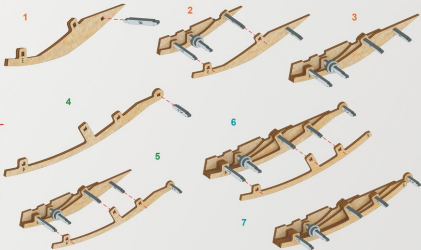
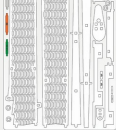

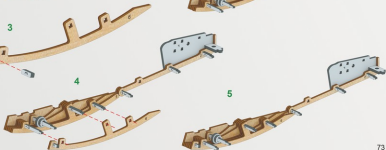
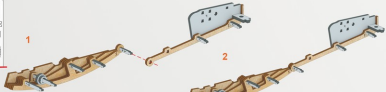
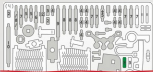

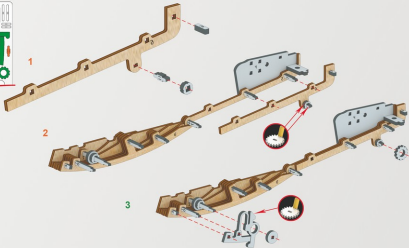
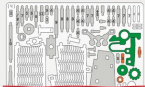

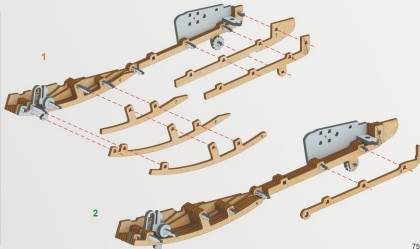
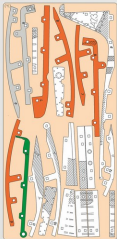

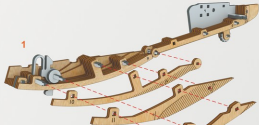

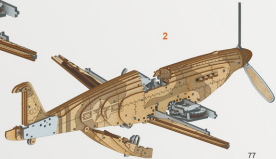
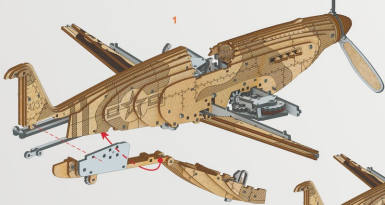

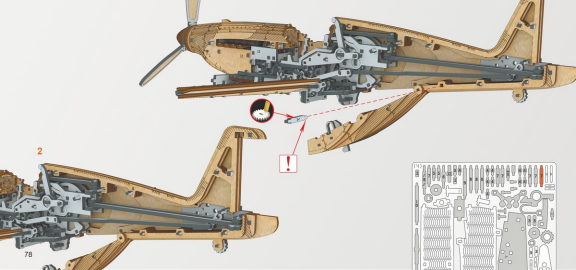

2



Part Number	Part Name	Quantity	Color
1	Propeller	1	Black
2	Propeller Nut	1	Black
3	Propeller Washer	1	Black
4	Propeller Pin	1	Black
5	Propeller Bracket	1	Black
6	Propeller Bracket Pin	1	Black
7	Propeller Bracket Washer	1	Black
8	Propeller Bracket Nut	1	Black
9	Propeller Bracket Pin	1	Black
10	Propeller Bracket Washer	1	Black
11	Propeller Bracket Nut	1	Black
12	Propeller Bracket Pin	1	Black
13	Propeller Bracket Washer	1	Black
14	Propeller Bracket Nut	1	Black
15	Propeller Bracket Pin	1	Black
16	Propeller Bracket Washer	1	Black
17	Propeller Bracket Nut	1	Black
18	Propeller Bracket Pin	1	Black
19	Propeller Bracket Washer	1	Black
20	Propeller Bracket Nut	1	Black
21	Propeller Bracket Pin	1	Black
22	Propeller Bracket Washer	1	Black
23	Propeller Bracket Nut	1	Black
24	Propeller Bracket Pin	1	Black
25	Propeller Bracket Washer	1	Black
26	Propeller Bracket Nut	1	Black
27	Propeller Bracket Pin	1	Black
28	Propeller Bracket Washer	1	Black
29	Propeller Bracket Nut	1	Black
30	Propeller Bracket Pin	1	Black
31	Propeller Bracket Washer	1	Black
32	Propeller Bracket Nut	1	Black
33	Propeller Bracket Pin	1	Black
34	Propeller Bracket Washer	1	Black
35	Propeller Bracket Nut	1	Black
36	Propeller Bracket Pin	1	Black
37	Propeller Bracket Washer	1	Black
38	Propeller Bracket Nut	1	Black
39	Propeller Bracket Pin	1	Black
40	Propeller Bracket Washer	1	Black
41	Propeller Bracket Nut	1	Black
42	Propeller Bracket Pin	1	Black
43	Propeller Bracket Washer	1	Black
44	Propeller Bracket Nut	1	Black
45	Propeller Bracket Pin	1	Black
46	Propeller Bracket Washer	1	Black
47	Propeller Bracket Nut	1	Black
48	Propeller Bracket Pin	1	Black
49	Propeller Bracket Washer	1	Black
50	Propeller Bracket Nut	1	Black
51	Propeller Bracket Pin	1	Black
52	Propeller Bracket Washer	1	Black
53	Propeller Bracket Nut	1	Black
54	Propeller Bracket Pin	1	Black
55	Propeller Bracket Washer	1	Black
56	Propeller Bracket Nut	1	Black
57	Propeller Bracket Pin	1	Black
58	Propeller Bracket Washer	1	Black
59	Propeller Bracket Nut	1	Black
60	Propeller Bracket Pin	1	Black
61	Propeller Bracket Washer	1	Black
62	Propeller Bracket Nut	1	Black
63	Propeller Bracket Pin	1	Black
64	Propeller Bracket Washer	1	Black
65	Propeller Bracket Nut	1	Black
66	Propeller Bracket Pin	1	Black
67	Propeller Bracket Washer	1	Black
68	Propeller Bracket Nut	1	Black
69	Propeller Bracket Pin	1	Black
70	Propeller Bracket Washer	1	Black
71	Propeller Bracket Nut	1	Black
72	Propeller Bracket Pin	1	Black
73	Propeller Bracket Washer	1	Black
74	Propeller Bracket Nut	1	Black
75	Propeller Bracket Pin	1	Black
76	Propeller Bracket Washer	1	Black
77	Propeller Bracket Nut	1	Black
78	Propeller Bracket Pin	1	Black
79	Propeller Bracket Washer	1	Black
80	Propeller Bracket Nut	1	Black
81	Propeller Bracket Pin	1	Black
82	Propeller Bracket Washer	1	Black
83	Propeller Bracket Nut	1	Black
84	Propeller Bracket Pin	1	Black
85	Propeller Bracket Washer	1	Black
86	Propeller Bracket Nut	1	Black
87	Propeller Bracket Pin	1	Black
88	Propeller Bracket Washer	1	Black
89	Propeller Bracket Nut	1	Black
90	Propeller Bracket Pin	1	Black
91	Propeller Bracket Washer	1	Black
92	Propeller Bracket Nut	1	Black
93	Propeller Bracket Pin	1	Black
94	Propeller Bracket Washer	1	Black
95	Propeller Bracket Nut	1	Black
96	Propeller Bracket Pin	1	Black
97	Propeller Bracket Washer	1	Black
98	Propeller Bracket Nut	1	Black
99	Propeller Bracket Pin	1	Black
100	Propeller Bracket Washer	1	Black

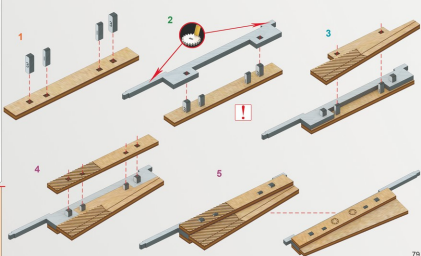
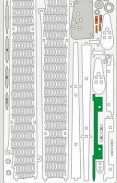



1

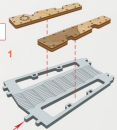

4

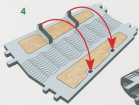

2

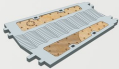

5

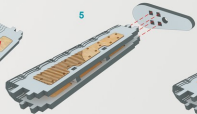

3

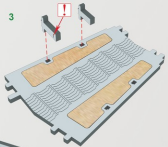

6



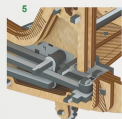
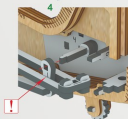
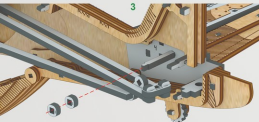
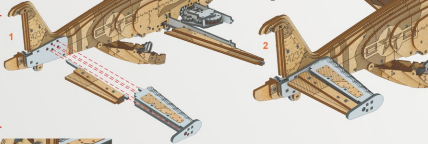

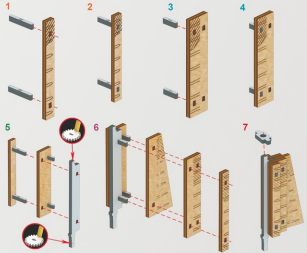
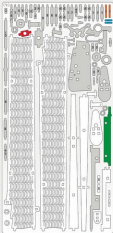

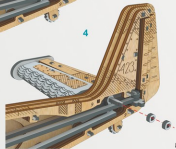
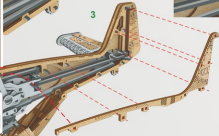
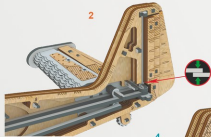
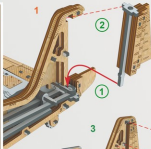
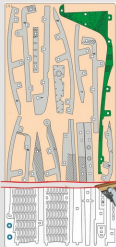

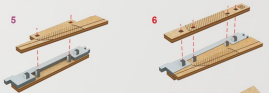
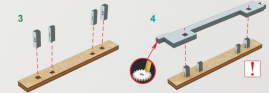
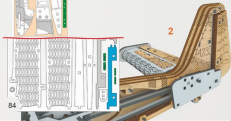
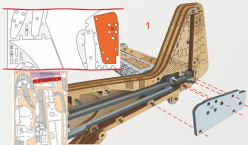

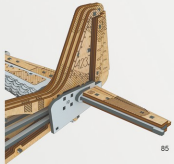
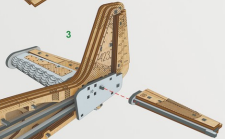
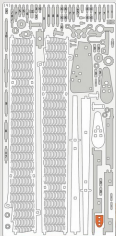

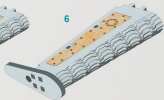
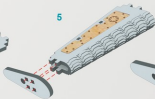
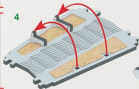
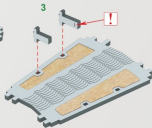
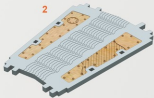
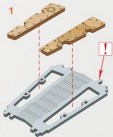
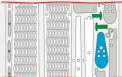
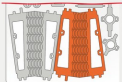

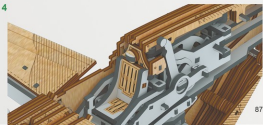
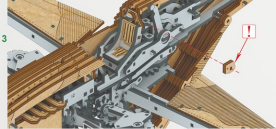
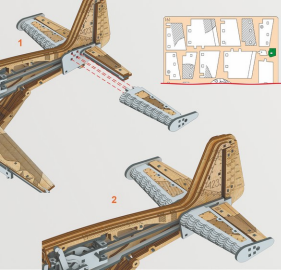

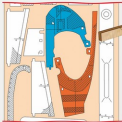

1



2



3



5



4



6



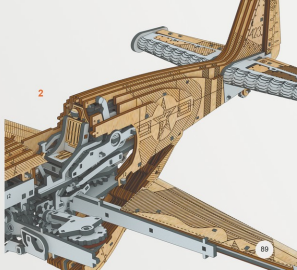
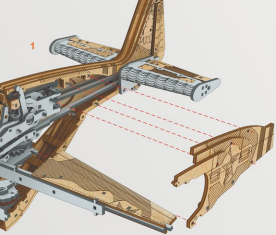

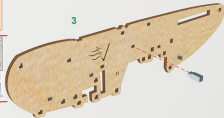
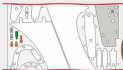

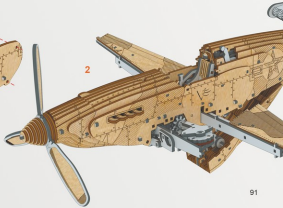
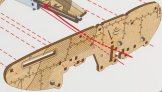
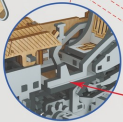
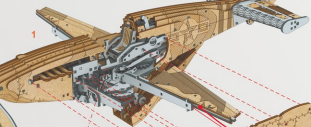

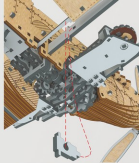
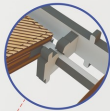
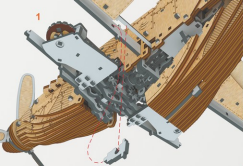

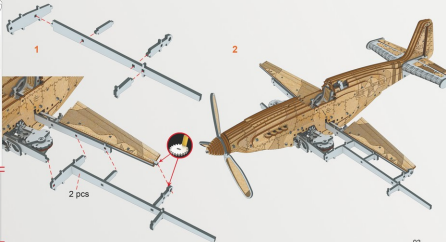

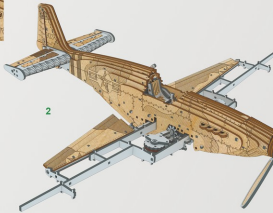
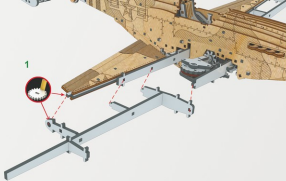

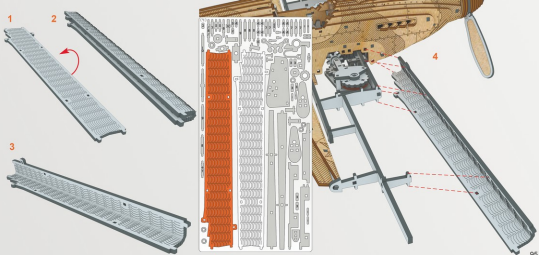

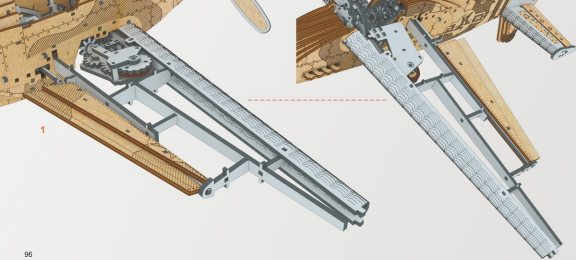

1

